

Designed By: Diane Nagle
Finished Quilt Size: 78" x 88"
Finished Block Size: 10" x 10"
Number of Blocks: (9) Star and (9) Square-in-a-Square



FABRIC REQUIREMENTS	
Design:	Yards
22548 D	2 $\frac{1}{3}$
22551 D (Incl. Binding)	1 $\frac{3}{4}$
22547 D	1 $\frac{1}{2}$
22549 S	$\frac{3}{4}$
22549 D	$\frac{3}{8}$
22546 S	2 $\frac{3}{4}$
22549 S (Backing)	7 $\frac{1}{4}$

Cutting Directions:

WOF = Width of fabric.

Note: Use a 1/4" seam allowance throughout unless otherwise directed. Label all pieces with the letters given in the cutting list. These letters are used to identify the pieces throughout the instructions.

22548 D: Border Stripe

- Fussy-cut (2) 5 $\frac{1}{2}$ " x 66" and (2) 5 $\frac{1}{2}$ " x 76" red border strips along length of fabric, centering the red part of the stripe in each strip.
- Fussy-cut (4) 5 $\frac{1}{2}$ " x 60 $\frac{1}{2}$ " G strips along length of fabric, centering the green part of stripe in each strip.

22551 D: Dark Pink Tonal

- Cut (3) 3 $\frac{3}{8}$ " x WOF strips. Recut strips into (36) 3 $\frac{3}{8}$ " squares. Cut each square in half on one diagonal to make (72) C triangles.
- Cut (6) 1 $\frac{1}{2}$ " x WOF inner border strips.
- Cut 2 $\frac{1}{2}$ "-wide bias strips to total 365" when joined.

22547 D: Dark Pink Floral

- Cut (3) 5 $\frac{7}{8}$ " x WOF strips. Recut strips into (18) 5 $\frac{7}{8}$ " squares. Cut each square in half on one diagonal to make (36) E triangles.

22549 S: Yellow Rosebuds

- Cut (2) 6 $\frac{1}{4}$ " x WOF strips. Recut strips into (9) 6 $\frac{1}{4}$ " squares. Cut each square on both diagonals to make (36) B triangles.
- Cut (3) 3" x WOF strips. Recut strips into (36) 3" D squares.

22549 D: Pink Rosebuds

- Cut (2) 5 $\frac{1}{2}$ " x WOF strips. Recut strips into (9) 5 $\frac{1}{2}$ " A squares.

22546 S: Yellow Large Floral

- Cut (2) 7 $\frac{5}{8}$ " x WOF strips. Recut strips into (9) 7 $\frac{5}{8}$ " F squares.
- Cut (8) 8 $\frac{1}{2}$ " x WOF outer border strips.

22549 S: Yellow Rosebuds (Backing)

- Cut (3) 86" x WOF strips for backing.

Making the Star Blocks:

1. Sew C to each short side of B to make a B-C unit; press seams toward C. Repeat to make a total of (36) B-C units.

Make 36



2. Sew a D square to each end of (18) B-C units to make a total of (18) top/bottom rows; press seams toward D.

Top/Bottom Row
Make 18



3. Sew a B-C unit to opposite sides of each A square to make (9) center rows; press seams toward A.

Center Row
Make 9



4. Sew a top/bottom row to opposite long edges of a center row to complete (1) Star block; press seams toward the center row. Repeat to make a total of (9) Star blocks.

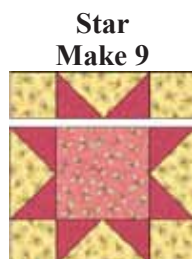

2. Join the vertical rows with the G strips, turning the center row end-for-end to complete the pieced center; press seams toward G strips.

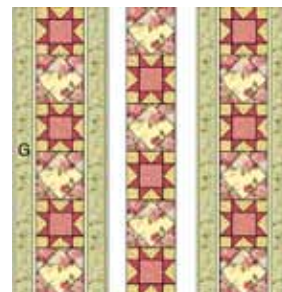

Making the Square-in-a-Square Blocks:

1. Sew an E triangle to opposite sides of an F square; press seams toward E. Sew an E triangle to the remaining sides of the E-F unit to complete (1) Square-in-a-Square block; press seams toward E.



Square-in-a-Square
Make 9

2. Repeat Step 1 to complete a total of (9) Square-in-a-Square blocks.

Quilt Assembly:

Note: Refer to the quilt diagram on page 1 for all steps.

1. Arrange and join (3) each Star and Square-in-a-Square blocks to make a vertical row; press seams open. Repeat to make (3) vertical rows.

Make 3



3. Join the 1½"-wide dark pink tonal inner border strips on the short ends to make a long strip; press seams open. Recut strip into (2) 1½" x 60½" side strips and (2) 1½" x 52½" top and bottom strips. Sew the longer strips to opposite long sides and shorter strips to the top and bottom of the pieced center.

4. Center and sew a 5½" x 76" red stripe middle border strip to opposite long sides of the pieced center, stopping stitching ¼" from ends of the pieced center. Repeat with the 5½" x 66" strips on the top and bottom. Miter corner seams, trim seam to ¼" and press seam open. Note: See Mitered border instructions (page 4) for further information.

5. Join the 8½" yellow large floral strips on the short ends to make a long strip; press seams open. Recut strip into (2) 8½" x 72½" side strips and (2) 8½" x 78½" top and bottom strips. Sew the longer strips to opposite long sides and shorter strips to the top and bottom of the pieced center; press seams toward strips.

6. Remove the selvedge edges from the backing pieces. Join the pieces on the 86" edges with a ½" seam allowance. Press seams open. Trim top and bottom edges to make an 86" x 96" backing with horizontal seams.

7. Layer and quilt as desired.

8. Mark off desired scallops using a measurement of 14½" for side border scallops and 15" for top and bottom border scallops. Complete a gentle curve around the 4 corners. Note: You may use your favorite scallop border tool to make the scallop shapes following the directions with the tool.

9. Bind edges using the prepared bias binding strips to finish.

While all possible care has been taken to ensure the accuracy of this pattern, we are not responsible for printing errors or the way in which individual work varies.

Mitered Border Instructions:

1. Lay the quilt top face up on an ironing board. Working with the upper right corner only, smooth out the right side flat on the surface, and lift the top border strip so it lays over the right border strip. See Diagram 1.

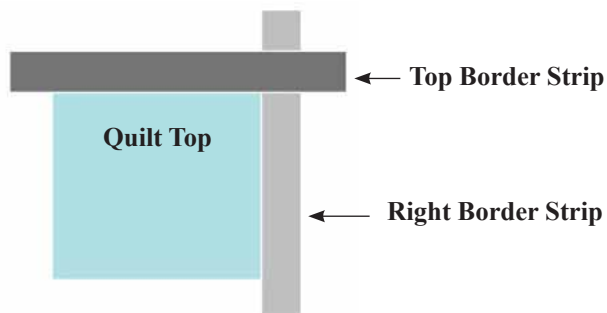

Diagram 1

2. Fold the top border strip UNDER at a 45-degree angle until the sides match up with the strip sides underneath. Press this fold into a hard crease. See Diagram 2.

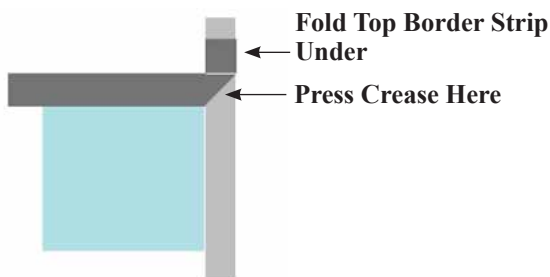

Diagram 2

3. Fold the entire block or quilt down and to the right, into a 45 degree angle, (making a triangle) matching the top border edges evenly with the right border edges. See Diagram 3.

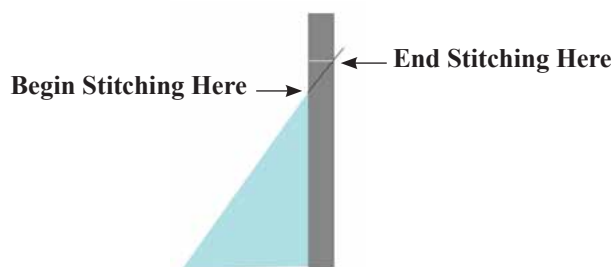

Diagram 3

4. The crease made in Step 2 will now be open so you can pin along the crease $\frac{1}{4}$ " from the inside corner point to the outer edge of borders with pins perpendicular to the crease line. This holds the border strips together.

5. Stitch from the inside corner point all the way across the crease line. Remove pins, trim seam to $\frac{1}{4}$ " and press from the front side of the quilt.